



3-phase busbar with infeed left for 2 circuit breakers Size S00 and S0

General technical data		
product brand name		SIRIUS
product designation		three-phase busbars with infeed
design of the product		for 2 switches with infeed on the left
size of the circuit-breaker		S00, S0
suitability for use		circuit-breakers 3RV2
protection class IP on the front acc. to IEC 60529		IP00; IP20 with cover and 25 mm ² conductor cross section at the infeed terminal
touch protection on the front acc. to IEC 60529		finger-safe, for vertical contact from the front with cover and 25 mm ² conductor cross section at the infeed terminal
Installation/ mounting/ dimensions		
mounting position		any
fastening method		snap-on fastening on 35 mm standard rail
width	mm	110
height	mm	129
depth	mm	86.5
operational current rated value	A	63
number of poles for main current circuit		3
type of electrical connection for main current circuit		spring-loaded terminals
required spacing for live parts		
• upwards	mm	10
• backwards	mm	0
• at the side	mm	0
required spacing for grounded parts		
• upwards	mm	10
• backwards	mm	0
• at the side	mm	0
required spacing with side-by-side mounting		
• upwards	mm	10
• backwards	mm	0
• at the side	mm	0
Certificates/ approvals		
General Product Approval		Declaration of Conformity
		Test Certificates



Miscellaneous

Special Test Certificate

Test Certificates	Marine / Shipping
-------------------	-------------------

Type Test
Certificates/Test
Report



Marine / Shipping	other	Railway
-------------------	-------	---------



Confirmation

Vibration and Shock

Further information

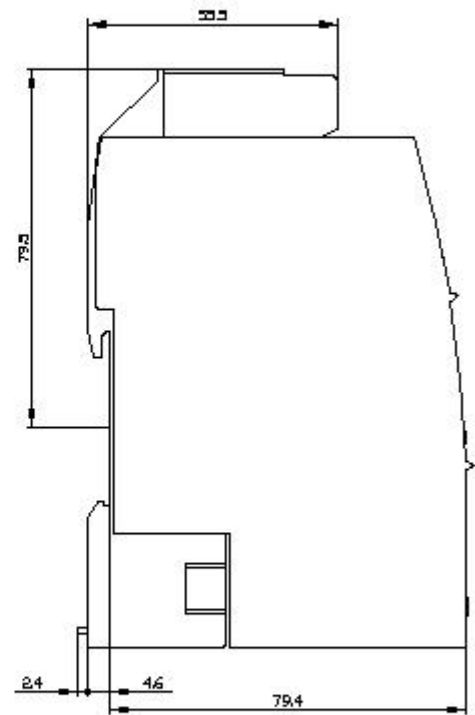
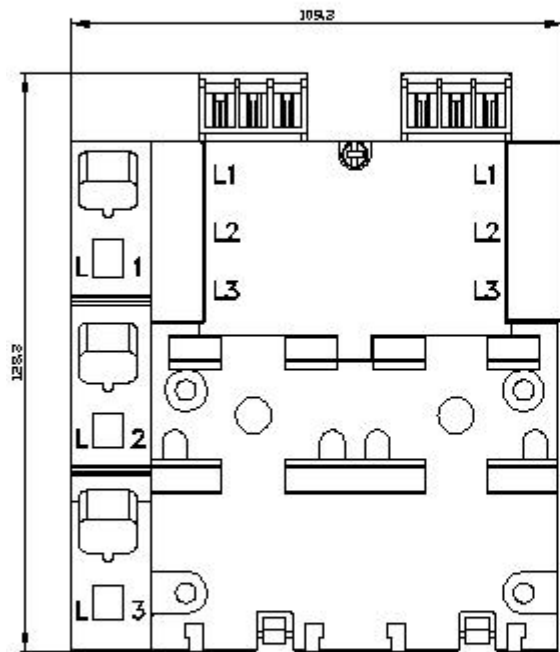

last modified:

12/15/2020 